



DESSMANN
FINGERPRINT LOCK

DESSMANN - FINGERPRINT LOCK

User Guide
G800FP - G800FPC

Contents

1	Introduction	4
1.1	Packing List	4
1.2	Technical Data	5
2	Product Description	6
3	Basic Instructions	7
3.1	Batteries Setup	7
3.2	System Start and Shutdown	7
3.2.1	Start	7
3.2.2	Shutdown	7
4	Quick Start	8
4.1	Open the Door	9
4.1.1	with Finger	9
4.1.2	with Card (G800FPC Only)	9
4.1.3	with Password	9
4.2	Close the Lock	10
5	Lock Menu	11
5.1	Enter the System Menu	11
5.2	System Settings	11
5.2.1	Unlock Mode	11
5.2.2	Set Password	12
5.2.3	Set Time	13
5.2.4	Unlocked Alarm	13
5.2.5	Connect to PC	13
5.3	Manager Users	13
5.3.1	Add Admin Fingerprint	14
5.3.2	Add User Fingerprint	14
5.3.3	Add Card (G800FPC Only)	15
5.3.4	Delete User	15
5.4	Information	15
5.4.1	Users Log	16
5.4.2	Users List	16
5.4.3	Storage	16
6	Lock Functions	17
6.1	Alarm Functions	17
6.1.1	Illegal Intrusion Alarm	17
6.1.2	Multi-attempts Alarm	17
6.1.3	Unlocked Door Alarm	17
6.2	Batteries Low	18
6.2.1	First Warning	18
6.2.2	Last Warning	18
6.3	Emergency Battery	18
6.4	Locker Function	19
6.4.1	Close Position	19
6.4.2	Open Position	19

6.5 Mechanical Key	19
6.6 Factory Reset	20
7 Product Warranty	21
8 Contact Us	22

Chapter 1

Introduction

1.1 Packing List

Thank you for choosing a DESSMANN lock.

The following accessories are provided in order to set up and use your smart lock:

Item	Qty	Item	Qty
01/ Lock Front Panel	1 Pce	06/ Lock Accessories	1 Set
02/ Lock Back Panel	1 Pce	07/ 1.5V Batteries	4 Pces
03/ Lock	1 Pce	08/ Reset Stick	1 Pce
04/ Mechanical Key	3 Pces	09/ Rubber Seal	2 Pces
05/ User Guide	1 Book	10/ Smart Card (G800FPC Only)	4 Cards

Please check all of the above accessories are included in the box before installation.

In case any of these items is damaged or missing, please contact us or your closest dealer.

Make sure that the mechanical keys can operate the lock.

1.2 Technical Data

Lock		
Dimensions	Front Panel (HxLxW)	302x70x28mm
	Back Panel (HxLxW)	302x70x25mm
Lock	Weather Resistant Body	•
	Locker Mechanism	•
	Hidden Mechanical Lock	•
	Power Supply	2 sets of 4 AA Batteries
	Emergency Power Supply	9V Battery
	Durability	Lock Tested More Than 100,000 openings
Interface	Screen	Dot-Matrix Screen
	Keypad	Touchscreen
Functions	Main Opening Method	Fingerprint
	Fingerprint Capacity	150 Fingerprints
	Alternative Opening Method (G800FPC Only)	Smart Card MF1 (13.56MHz)
	Card Capacity (G800FPC Only)	100 Cards
	Alternative Opening Method	Password, Mechanical Key
	Password Capacity	1 Password
	Time Display	•
	Low Power Notification	•
	System Reset Button	•
Security	Admin Authentication	Admin Fingerprint
	Registered User Identification	By Name
	Users Log-In Record	1,024 entries
	Failed Fingerprint Authentication	System Freeze for 3 Minutes after 3 Failed Attempts
	Failed Card Authentication	System Freeze for 3 Minutes after 3 Failed Attempts
	Failed Password Authentication	System Freeze for 3 Minutes after 3 Failed Attempts
	Save Data when System is Down	•
	Wrapped Password	•

Due to continuous improvements, we reserve the right to amend any aspect of the above specifications without notice.

Chapter 2

Product Description

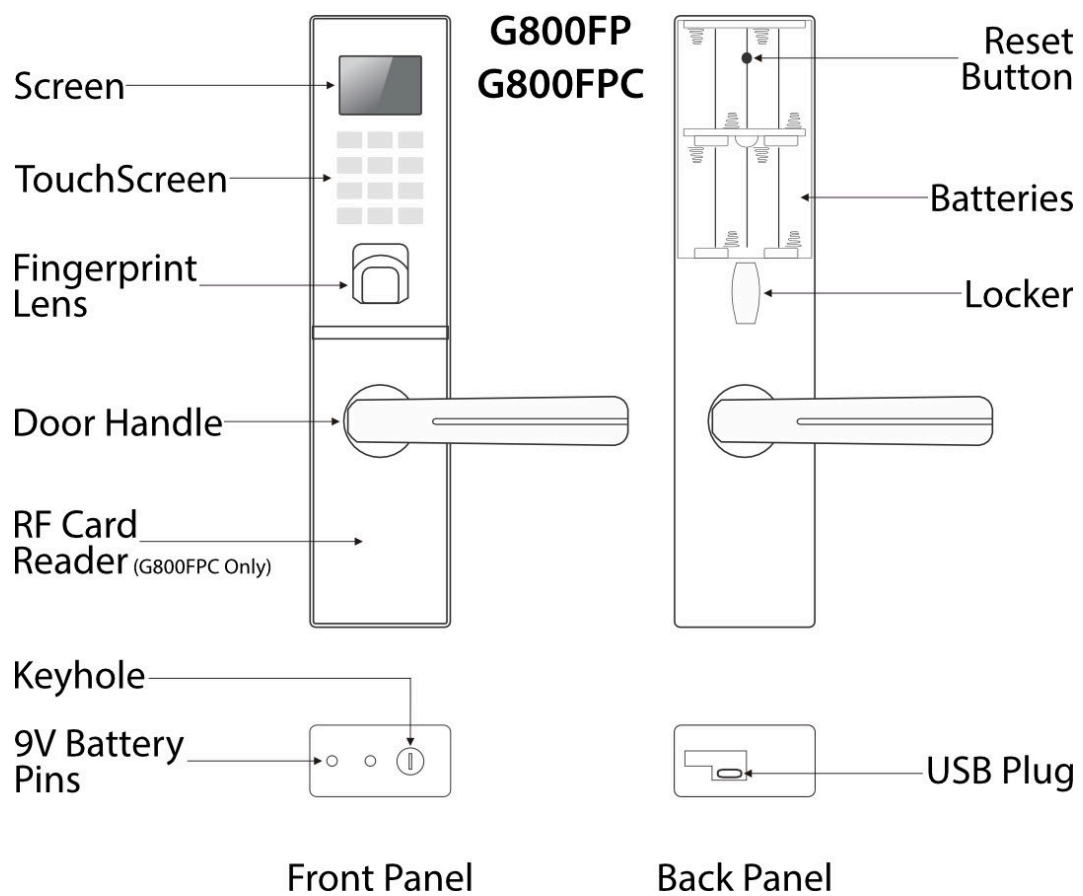

Numeric Keys: Input Password and Name

MENU: Enter the Menu or Go to Previous Menu

ENTER: Save or Confirm

↑: Scroll Up

↓: Scroll Down

Chapter 3

Basic Instructions

3.1 Batteries Setup

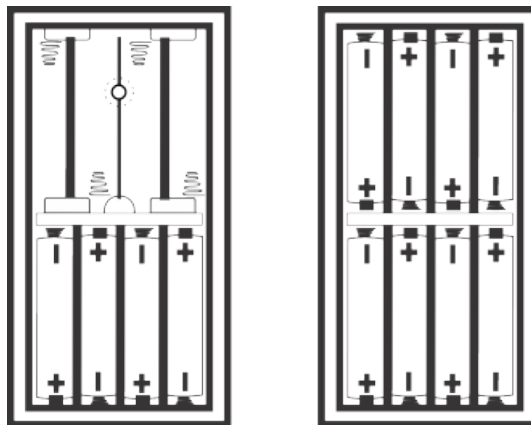

One set of 4 AA batteries or two sets of 4 AA batteries are required to power the lock.

3.2 System Start and Shutdown

3.2.1 Start

Make sure the batteries are properly installed, then start the system as follows:

- Scan your fingertip at the authentication lens

OR

- Press the TouchScreen

OR

- Scan a Card (G800FPC Only)

The screen will lighten up after system start

3.2.2 Shutdown

System will automatically shutdown when not in use.

Chapter 4

Quick Start

Functions		Operation
Enter	System Menu	1/ Start the System 2/ Press MENU 3/ Scan Admin Fingerprint (Default: none)
New	Admin	1/ Enter System Menu 2/ Select "2.User Setting" 3/ Select "1.Add Admin FP" 4/ Scan Fingertip Twice 5/ Enter a Name. ENTER to Save
	Fingerprint User	1/ Enter System Menu 2/ Select "2.User Setting" 3/ Select "2.Add User FP" 4/ Scan Fingertip Twice 5/ Enter a Name. ENTER to save
	Card User (G800FPC Only)	1/ Enter System Menu 2/ Select "2.User Setting" 3/ Select "3.Add Card" 4/ Scan Card Twice 5/ Enter a Name. ENTER to save

4.1 Open the Door

4.1.1 with Finger

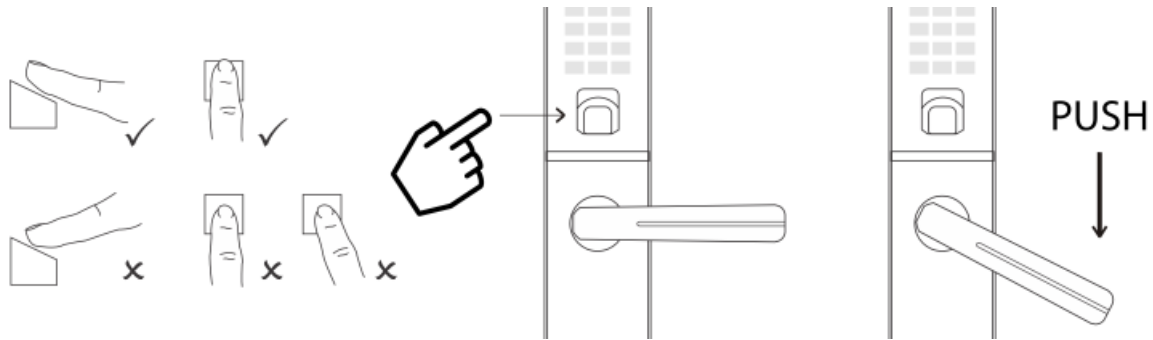

Scan your fingertip on the authentication lens. Push the handle.

Best Practices

To guarantee an optimal authentication:

- Make sure your finger is clean & dry
- Align your finger parallel to the authentication lens
- Do not move your finger for 2 seconds while scanning

4.1.2 with Card (G800FPC Only)

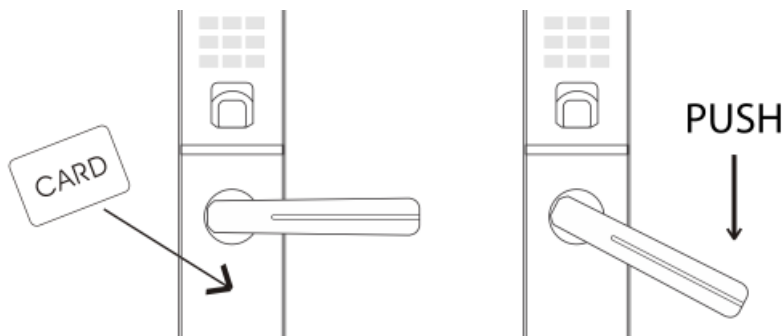

Scan card to unlock the door. Push the handle.

4.1.3 with Password

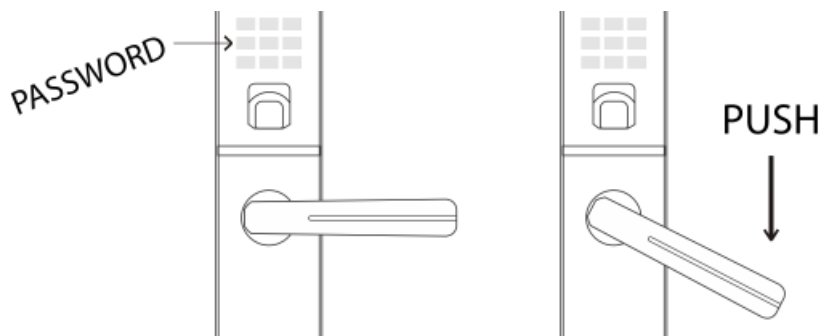

Enter password & press **ENTER** to unlock the door. Push the handle.



Smart Password

To confuse people looking at you when you type your password, it can be inputted within a random string of number. If your password is **888888**, the following combinations will still unlock the door:

- 1289888888
- 8888887556
- 87463888888451879

4.2 Close the Lock

The 3 locking bolts automatically close when you close the door.

Chapter 5

Lock Menu

DESSMANN lock management software let you easily manage your users. Browse with the arrows keys & press **ENTER** to confirm each step.

5.1 Enter the System Menu

System can only be managed with the admin fingerprint.
Start system (3.2.1) and press **MENU** twice:



Scan admin fingerprint (default: none).

5.2 System Settings

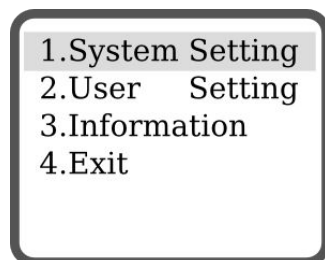

5.2.1 Unlock Mode

Notes: FP for Fingerprint, PWD for Password

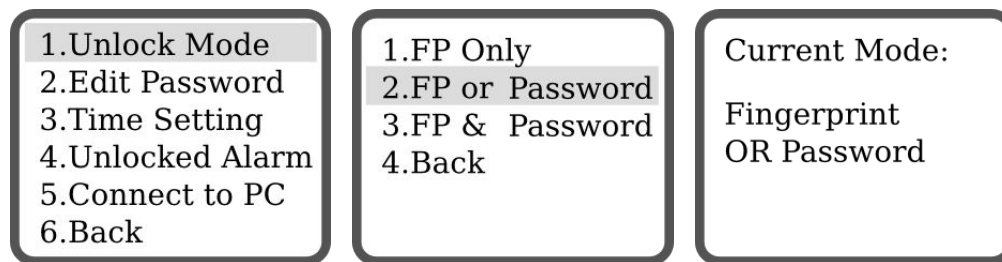
G800FP

There are 3 modes offered by G800FP lock to open the door:

- **Fingerprint Only** - Identification with fingerprint only
- **Fingerprint OR Password** - Identification with either fingerprint OR password
- **Fingerprint AND Password** - Identification with fingerprint AND password

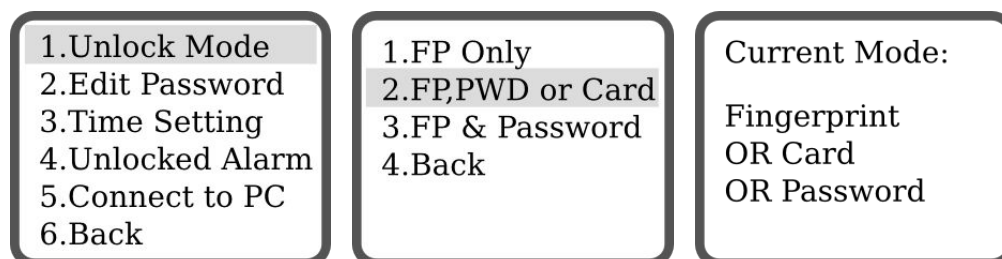
G800FPC

There are 3 modes offered by G800FPC lock to open the door:

- **Fingerprint Only** - Identification with fingerprint only
- **Fingerprint OR Card OR Password** - Identification with either fingerprint OR password OR Card
- **Fingerprint AND Password** - Identification with fingerprint AND password

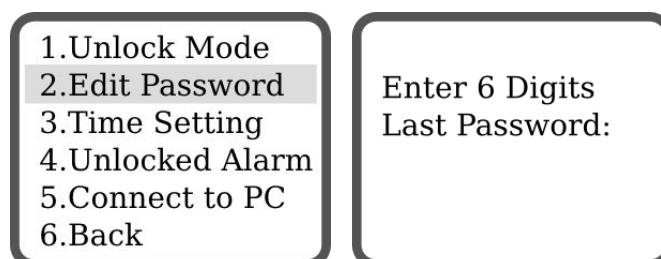
5.2.2 Set Password

Enter the last password in use and press **ENTER**. (Default: 888888)

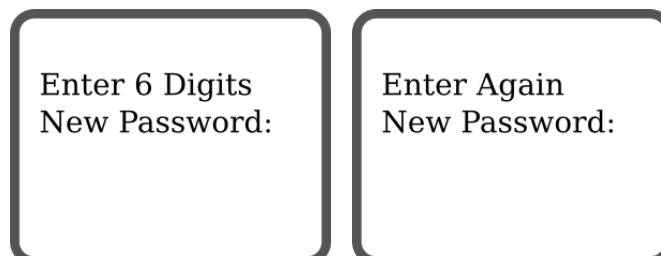

Enter the new password (must be 6 digits, no more, no less), press **ENTER**, confirm it again, press **ENTER**.

5.2.3 Set Time

We recommend you to properly set the time to fully enjoy all the functions of your lock.

1.Unlock Mode 2.Edit Password 3.Time Setting 4.Unlocked Alarm 5.Connect to PC 6.Back	Time Setting 10:21:25 2013/05/30
---	--

Change the values with the keypad. Press **ENTER** to confirm.

5.2.4 Unlocked Alarm

1.Unlock Mode 2.Edit Password 3.Time Setting 4.Unlocked Alarm 5.Connect to PC 6.Back	1.ON 2.OFF 3.Back
---	-------------------------

Switch ON or OFF the Unlocked door alarm. When turn ON, an alarm sound will buzz when the lock bolts are not properly triggered.

5.2.5 Connect to PC

The log-in record can be extracted directly to a computer.

1.System Setting 2.User Setting 3.Information 4.Exit	1.Unlock Mode 2.Edit Password 3.Time Setting 4.Unlocked Alarm 5.Connect to PC 6.Back	Connect to PC? ENTER to Confirm MENU to Cancel
---	---	--



Connection Tutorial

Please contact us or your closest dealer to learn how to connect your lock to your computer.

5.3 Manager Users

1.System Setting 2.User Setting 3.Information 4.Exit

5.3.1 Add Admin Fingerprint

1.Add Admin FP 2.Add User FP 3.Add Card 4.Delete User 5.Back	Scan Fingerprint	Scan Again
--	------------------	------------

Scan the new admin fingertip twice.

Enter Name: ENTER to Confirm MENU to Move	mark Saved
---	------------

Enter a name for this admin using the keypad. The name can only have a maximum of 6 digits or characters. Press **MENU** to move to the next character. Press **ENTER** to confirm.



Attention

Pay special attention to the following:

- The admins can manage the whole system, choose them carefully
- Up to 10 admins can be registered in the system
- Only a factory reset can delete admins from the system
- Use a distinctive finger for admin tasks & for everyday use

5.3.2 Add User Fingerprint

1.Add Admin FP 2.Add User FP 3.Add Card 4.Delete User 5.Back	Scan Fingerprint	Scan Again
--	------------------	------------

Scan the new user fingertip twice.

Enter Name: ENTER to Confirm MENU to Move	rachel Saved
---	--------------

Enter a name for this user using the keypad. The name can only have a maximum of 6 digits or characters. Press **MENU** to move to the next character. Press **ENTER** to confirm.

**Best Practices**

To ensure optimal results, register the same finger 2 to 3 times.

5.3.3 Add Card (G800FPC Only)

1.Add Admin FP
2.Add User FP
3.Add Card
4.Delete User
5.Back

Scan Card

Scan
New Card

Scan Again

Scan the new card twice.

Enter Name:

ENTER to Confirm
MENU to Move

rachel
Saved

Enter a name for this card using the keypad. The name can only have a maximum of 6 digits or characters. Press **MENU** to move to the next character. Press **ENTER** to confirm.

**Smart Card & Tag**

Any empty Smart Card or Tag MF1 (13.56MHz) can be registered in the system. Try with your office tag or electronic ID card.

5.3.4 Delete User

1.Add Admin FP
2.Add User FP
3.Add Card
4.Delete User
5.Back

Admin	mark
User	steven
User	rachel
Card	rachel
User	mark
	001/002

Select the user you want to delete with the arrows keys & press **ENTER** to confirm.

Note: Admin cannot be deleted.

5.4 Information

1.System Setting
2.User Setting
3.Information
4.Exit

5.4.1 Users Log

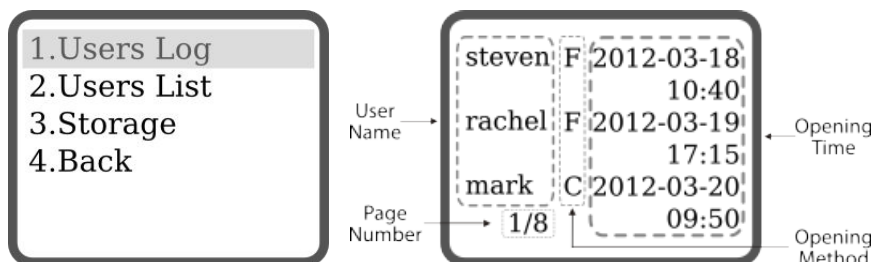

Users log informs you about:

- User Name
- Opening Method
 - **F** for Fingerprint
 - **C** for Card (G800FPC Only)
 - **P** for Password
 - **X** for Fingerprint & Password
- Opening Time

Change page with the arrows keys & press **ENTER** to exit.

5.4.2 Users List

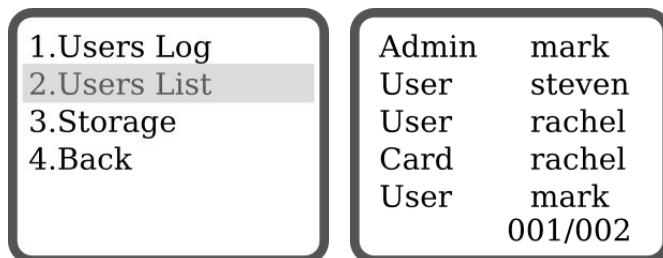

Users list informs you about registered user in the system. Change page with the arrows keys & press **ENTER** to exit.

5.4.3 Storage



Storage informs you about how many users are registered in the system and how many new users can be enrolled. Press **ENTER** to exit.

- **Total** - Total of password & card slots in the system
- **In Use** - Total of password & card allocated to the users
- **Free** - Total of password & card available to register new users

Chapter 6

Lock Functions

6.1 Alarm Functions

6.1.1 Illegal Intrusion Alarm

If an illegal intrusion occurs, such as a thief trying to pick-lock your door, a buzzer will ring and the following will be displayed:



6.1.2 Multi-attempts Alarm

After 3 failed authentications with fingerprint or password, the system will freeze for 3 minutes.



6.1.3 Unlocked Door Alarm

If the door is not properly closed, a buzzer will ring and the door will display the following for 30 seconds.

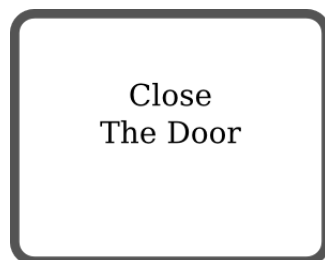

6.2 Batteries Low

- When the batteries are low, a buzzer will bip as a warning when you open the door & a message will be displayed on the screen at the same time.
- The lock will still operate for about 250 times after the first warning. Replace the batteries as soon as possible.
- Check the system time after batteries replacement, because time information will be stored only 2 minutes without power.
- Recycle the used batteries according to the related laws and regulations of your country.
- 3 different warnings will inform you about the state of your batteries:

6.2.1 First Warning

At first warning, the door can still operate for about 250 times.

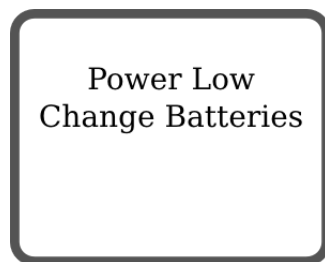

6.2.2 Last Warning

At last warning, the lock cannot operate anymore, you should use the emergency battery or the mechanical key.

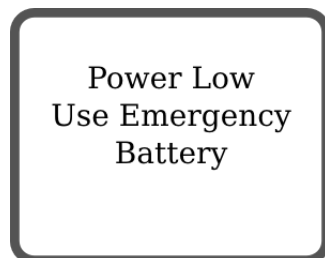

6.3 Emergency Battery

In case the lock runs out of battery. You can power the system with a 9V battery.

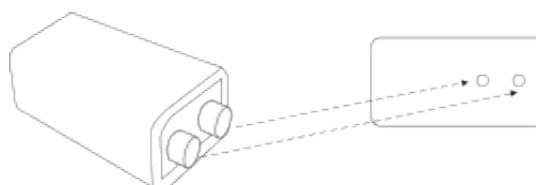

Just plug a 9V battery on the 2 pins located below the front panel and you can operate your lock as usual. Don't forget to change your batteries afterward.

6.4 Locker Function

6.4.1 Close Position

When the 3 locking bolts are out, turn the locker upwards. The lock will always be close. Nobody can open the door from outside (either with Fingerprint, Password, Card or Mechanical Key).



6.4.2 Open Position

When the 3 locking bolts are inside the lock, turn the locker upwards. The lock will always be open. The door can always be opened from the outside.

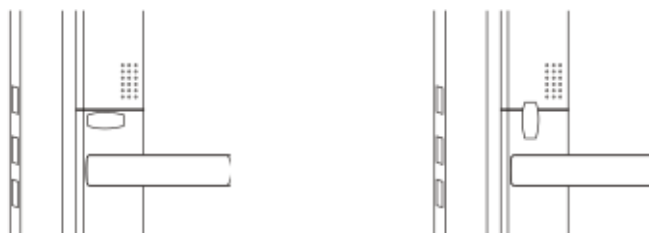

6.5 Mechanical Key

In case of system failure or damage, the lock can still be opened with a key. The keyhole is located at the bottom of the front panel.

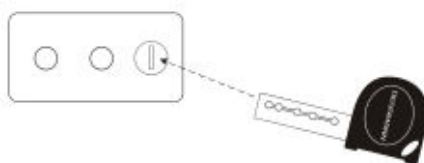

We advise you to leave the keys outside of your house, so you can get one of them in case of emergency.

6.6 Factory Reset



Attention

Factory reset will delete all the datas in the system:

- Admin Fingerprints
- User Fingerprints
- Password
- Log-in Record
- Time

Steps to proceed to a factory reset:

1. Open the battery cover, leave one set of 4 batteries and take one single battery out
2. Keep press **Reset Button** with the Reset Stick and re-install the battery

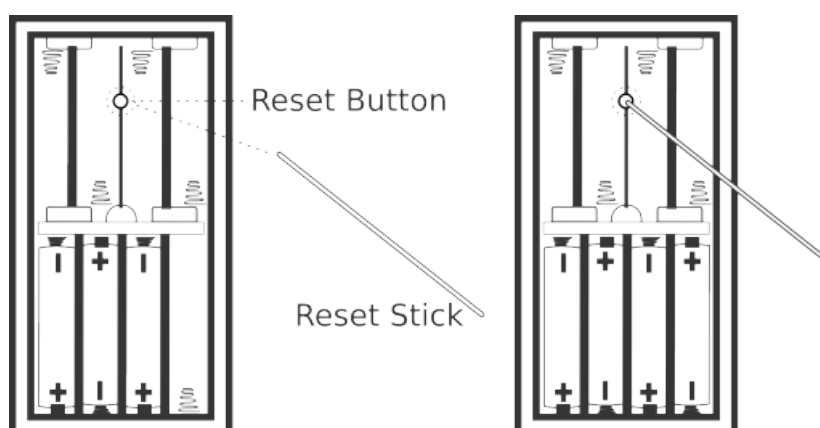

3. "Factory Reset?" will display on the screen, press **ENTER** to confirm. Factory settings are restored.

Factory Reset ?
ENTER to Confirm
MENU to Cancel

Factory Reset
In Progress

Factory Reset
Successful

Chapter 7

Product Warranty

DESSMANN warrants to the original purchaser that the hardware product shall be free from defects in material and workmanship for twelve (12) months from the date of purchase.

If a defect covered by this warranty occurs during this warranty period, DESSMANN or a DESSMANN AUTHORIZED REPAIR CENTER will repair the defective hardware product or component, free of charge. The original purchaser is entitled to this warranty only if the date of purchase is registered at point of sale or the consumer can demonstrate, to DESSMANN's satisfaction, that the product was purchased within the last 12 months.

SERVICE AFTER EXPIRATION OF WARRANTY

Please try our website at www.dessmannlock.com or call the Consumer Assistance Hotline at 0086-40060-00028 for troubleshooting information and/or referral to the nearest DESSMANN AUTHORIZED REPAIR CENTER. In some instances, it may be necessary for you to ship the complete product, FREIGHT PREPAID AND INSURED FOR LOSS OR DAMAGE, to the nearest service location. Please do not send any products to Dessmann without contacting us first.

WARRANTY LIMITATIONS

THIS WARRANTY SHALL NOT APPLY IF THIS PRODUCT:

1. IS MODIFIED OR TAMPERED WITH
2. IS DAMAGED BY NEGLIGENCE, ACCIDENT, UNREASONABLE USE, OR BY OTHER CAUSES UNRELATED TO DEFECTIVE MATERIALS OR WORKMANSHIP
3. HAS BEEN ASSEMBLED OR DISASSEMBLED, REPAIRED OR INSTALLED WITHOUT PERMISSION
4. HAS BEEN DAMAGED BY THE BATTERIES
5. AS HAD THE SERIAL NUMBER ALTERED, DEFACED OR REMOVED.

ANY APPLICABLE IMPLIED WARRANTIES, INCLUDING WARRANTIES OF MERCHANTABILITY AND FITNESS FOR A PARTICULAR PURPOSE, ARE HEREBY LIMITED IN DURATION TO THE WARRANTY PERIODS DESCRIBED ABOVE (12 MONTHS). IN NO EVENT SHALL DESSMANN BE LIABLE FOR CONSEQUENTIAL OR INCIDENTAL DAMAGES RESULTING FROM THE BREACH OF ANY IMPLIED OR EXPRESS WARRANTIES.

Chapter 8

Contact Us

Maintenance, Repair & Operations

Tel: +86 571 8711 9266

Fax: +86 571 8711 9299

Mail: mro@dessmannlock.com

www.dessmannlock.com